



Installation instruction data display Toyota GR Yaris

Preface

Thank you for purchasing the MFD32 for your Toyota GR Yaris.

During the development of the product, we paid high attention to accuracy and quality. With these installation instructions, the display was trial-assembled by several test persons and continuously improved, so that you do not have any problems during the installation.

If you have any feedback, criticism or change requests, please send us an email to info@canchecked.de.

We have both LHD and RHD version. In this instruction we concentrate in the LHD version. RHD is mirrored and where applicable we added comments in differences.



General information

The display unit is a very sensitive device. One should act with extreme caution and avoid any pressure on the housing or the display itself.

CANchecked assumes no liability for this conversion or for damage during the conversion or operation. The instructions were created to the best of our knowledge and belief.

The conversion time is approx. 1.5 hours for an experienced car enthusiast.

Needed tools

- Assembly tool (orange in the picture – separately available)
- Pull-through aid (wire)
- 10mm screwing tool or ratchet with 10mm socket
- Torx20 nut for ratchet

1) Remove the air vent

Open the driver side door and remove the side cover of the dashboard, so you can see the air duct from the side.

Now use the assembly tool to carefully pry off the air vent.



You can pull the whole vent from its place and put it on a table for further disassembling.

2) Cable installation

Remove the two screws for the lower cover of your driver side legroom



Fold the cover down and find the OBD port as well as the hole right next to it. This is where we route the cable through.



Pull the connection cable with its two connectors up to the open hole of the airvent



3) Installation of the fuse adapter

On the OBD plug you can find a red cable for your switched 12V feed. Please pull the red cable also through the same hole as the two plugs before.

Remove the insulation for about 1cm from the end of the red cable and crimp the included fuse adapter with a plier.

Remove the cover of the fuse box (on RHD cars the fuse box is on the passenger side)

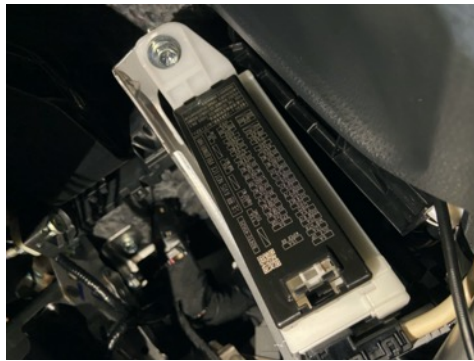

Find the Fuse “USB No.1” and remove it. Install the fuse adapter right in that place. The cover of the fuse box does not fit anymore. Please leave it in the car in case you need it in the future.



4) Remove the air vent cover

The coloured front cover is holden by several tabs. Gently lift them to remove the cover from the air duct.

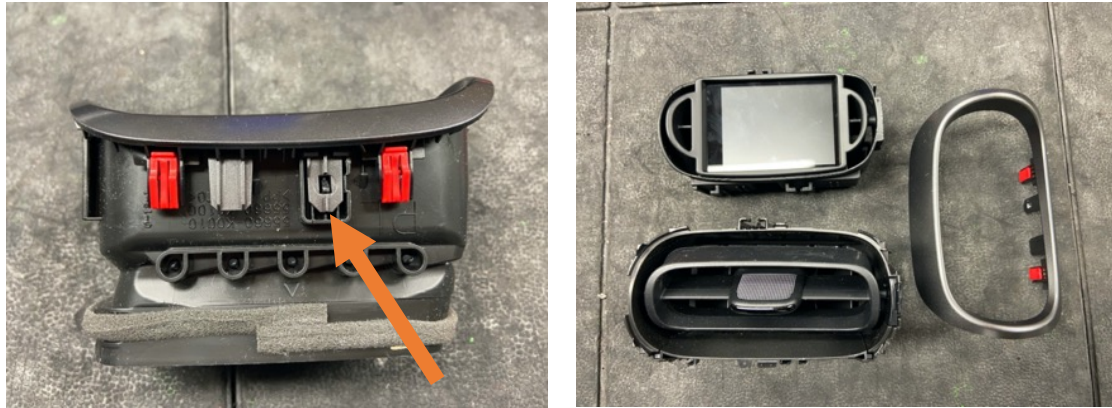

The cover fits the CANchecked unit exactly the same way. Slide the cover over the display unit and make the tabs click into their place.



5) Plug in the display

Plug in the two plugs (orange arrows) on the back of the display as well as the USB cable (green arrow) on the side of the display (for future updates or to setup with our DSS – Display Setup Software). Route the cables in direction of the USB port.



Remove the black screw from the back of the housing (blue arrow). Click in the air duct adapter and fix it with the black screw.

Turn on ignition to see if the display lights up and if you can see values other than zero on the display. If needed, select the GR Yaris TRX file on the first display startup and tap on “load”.

When everything works, leave the USB cable connected and hide it behind the side cover. Slide the display unit back until you hear a click and it sits firm.

6) Conclusion

We hope you have as much fun with your CANchecked Display as we do. If you have any questions, please send an email to info@canchecked.de.

We also have a support group on Facebook, where other customers can help and share their experiences:

<https://www.facebook.com/groups/CANcheckedSupport/>